



POWER DISTRIBUTION UNIT (PDU)

Giganet Metered Vertical 10c13/6c19 32Amp PDU

Description

32Amp 230V

The Giganet Metered PDU / Power Distribution Units offer real-time local reporting of load level in amps via built-in digital meter. Enables visual current monitoring of PDU output current to prevent circuit overloads as additional equipment is added. Offers reliable rack mount multi-outlet power distribution from any protected UPS, generator or mains input power source. High quality design includes rugged all-metal housing and secure rack mount installation with included mounting accessories. The PDU 1.6/3.8kW Two-Phase 100–240V meets IEC 60309 and UL-940V standards .

Specifications

OVERVIEW	
PDU Type	Basic / Metered
ELECTRICAL SPECIFICATIONS - OUTPUT	
Output Capacity Details	3.84kW (240V), 3.68kW (230V), 3.52kW (220V), 3.33kW (208V), 3.2kW (200V), 2.03kW (127V), 1.92kW (120V), 1.6kW (100V) / 32A total capacity; 16A max per C19 outlet; 12A (10A CE) max per C13 outlet
Frequency Compatibility	50 / 60 Hz
Output Receptacles	(10) C13 (6) C19;
Output Nominal Voltage	230; 240
Overload Protection	32A circuit breaker
ELECTRICAL SPECIFICATIONS - INPUT	
PDU Input Voltage	230; 240
Recommended Electrical Service	32A 230V
Maximum Input Amps	32
PDU Plug Type	IEC 60309 32A Plug
Input Cord Length (ft.)	10
Input Cord Length (m)	3.05
Input Phase	Two-Phase
PHYSICAL	
Color : RAL xxx Black	
Form Factors Supported	0U vertical rackmount installation supported with included mounting brackets; supports toolless mounting in buttonmount compatible racks
PDU Form Factor	0U Vertical
Material of Construction	Metal
ENVIRONMENTAL	
Storage Temperature Range	5 to 140F (-15 to 60C)
Relative Humidity	5 to 95% non-condensing
Operating Elevation (ft.)	0-10,000
Operating Elevation (m)	0-3000
CERTIFICATIONS	
Certifications	Tested to UL60950-1 (USA), CSA (Canada), CE (EU)
WARRANTY	
Product Warranty Period (Worldwide)	2-year limited warranty

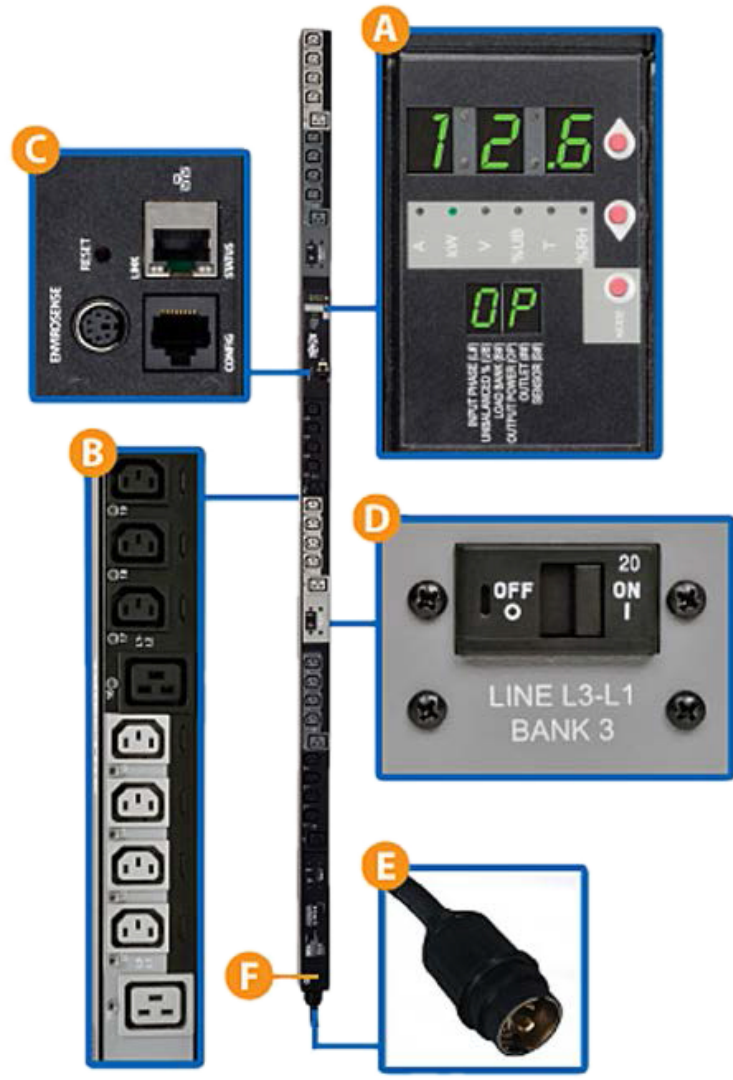
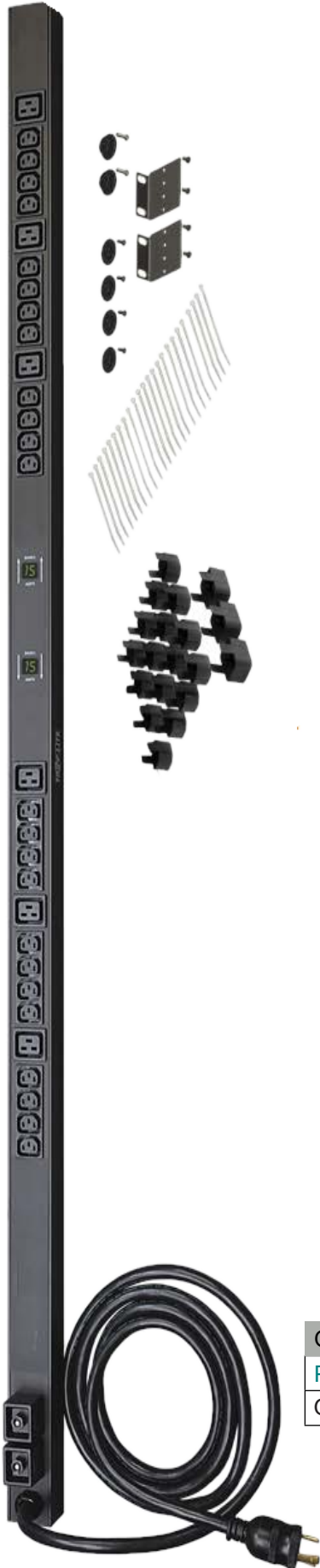

- A** Digital Meter Rotates 180 Degrees
- B** 16 Outlets
10XC13 6X C19
- C** Network Interface
- D** 32A Circuit Breaker
- E** 10 Feet Power Cord with IEC 60309 Plug
- F** Metal Housing

ORDERING INFORMATION	
Product Description	Part Number
Giganet 32A, 230V 2 Phase 10C136C19 Vertical PDU	GN-2PH-10C13/6C19-32A-V